

1989 FEMA MAP

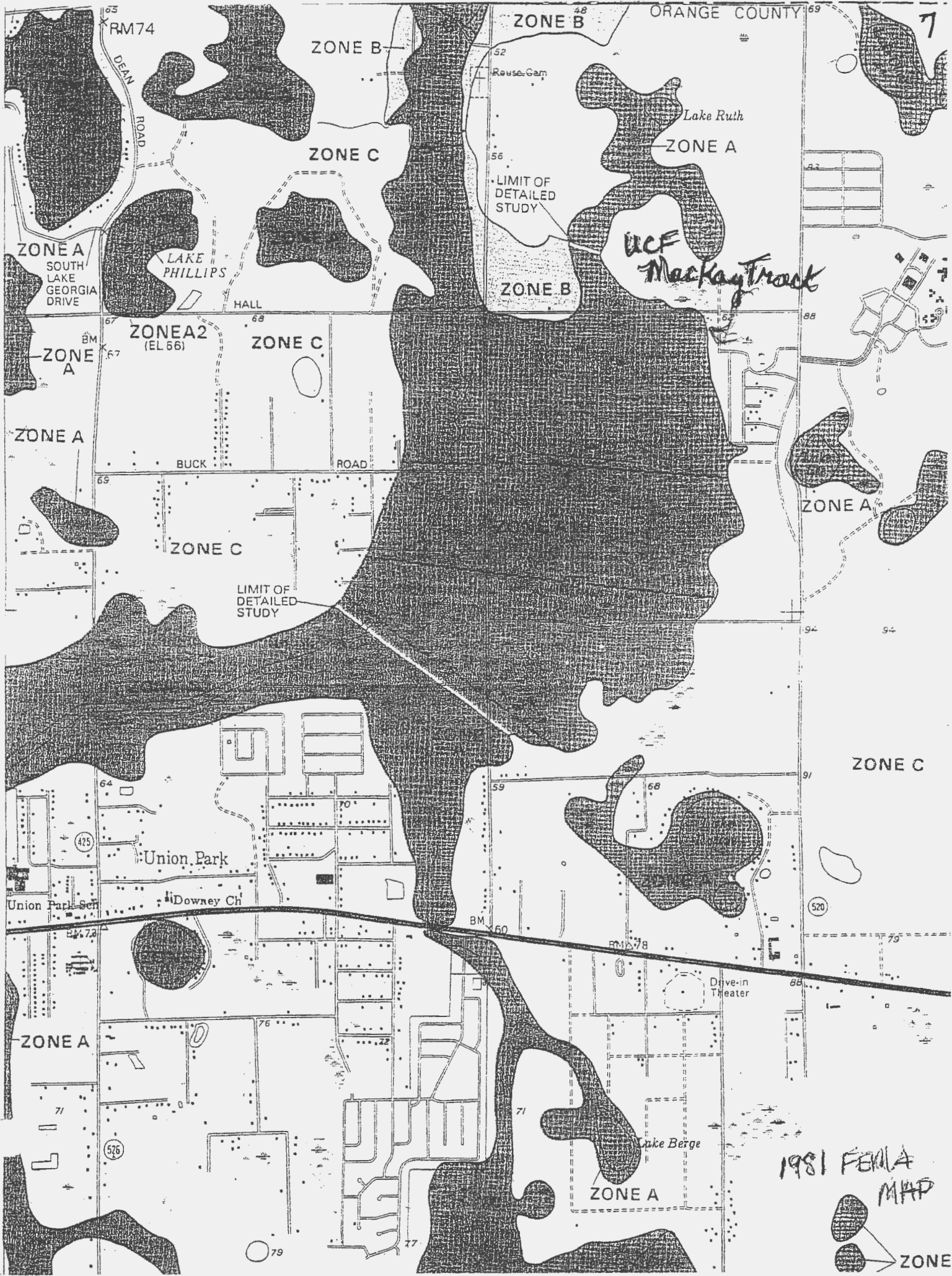

JOINS PANEL 225

1981 FERLA MAP

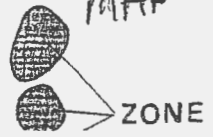

JOINS PANEL 0186

ZONE X

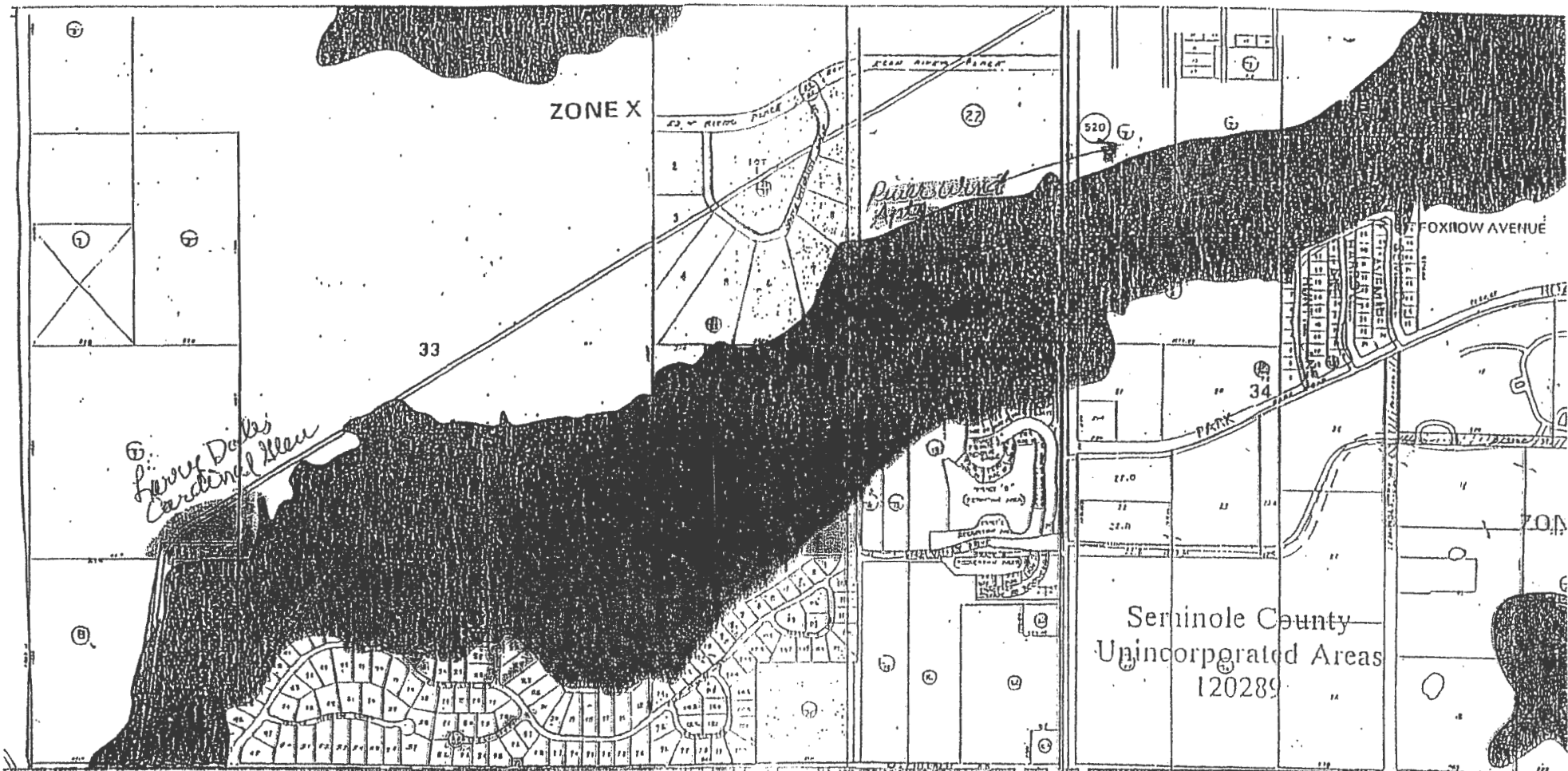

*Henry Dobb's Cardinal View*

*Riverwalk*

BOUNDARY *McCulloch Rd.* ORANGE COUNTY

Seminole County  
Unincorporated Areas  
120289

FIRM  
 Flood Insurance Rate Map  
 Seminole County, Florida and Incorporated Areas  
 Panel 230 of 260  
 Community number 120289  
 Map Number 12117C0230E  
 Effective Date April 17, 1995

FIRM (FEMA)  
 100 year flood plain map  
 AFTER  
 1985 Floodplain Study  
 by Ishio, Singhofen & Assoc.

JOINS PANEL 166

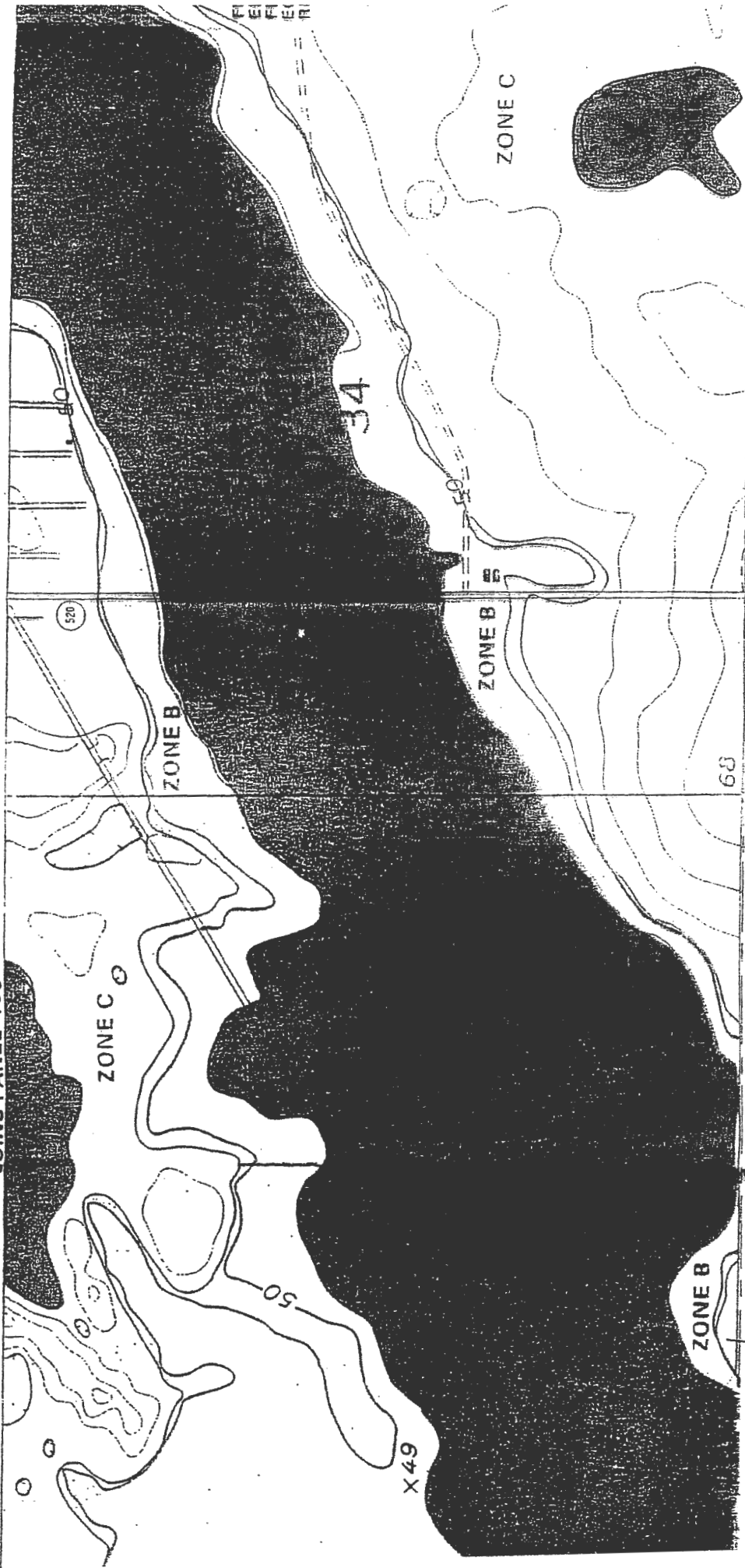

Riverwalk

FIRM (FEMA)

100 year floodplain map

BEFORE

1985 Floodplain study

by Shinto, Singhopon & Assoc

FIRM Insurance Rate Map

Seminole County, Florida (Incorporated as a...

Panel 30 of 300 Number 120289 02507

Effective Date: May 5, 1981