









<p>T1</p> 	<p>T2</p> 	<p>T3</p> 	<p>T4</p> 	<p>T5</p> 	<p>T6</p> 
					
<p>T1 Natural Predominantly lands in a wilderness condition</p>	<p>T2 Rural Predominantly open & farmed lands that are sparsely settled.</p>	<p>T3 Suburban Predominantly, low-density, low-rise buildings on large blocks</p>	<p>T4 General Urban Predominantly ground-oriented buildings of 4 storeys or less.</p>	<p>T5 Urban Centre Predominantly medium-density buildings of 6 storeys or less.</p>	<p>T6 Urban Core Predominantly high-density buildings greater than 6 storeys.</p>

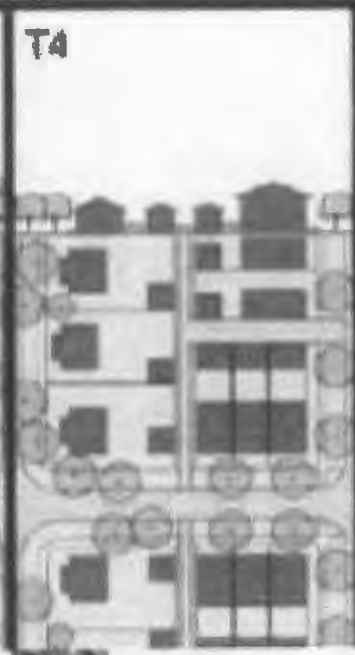
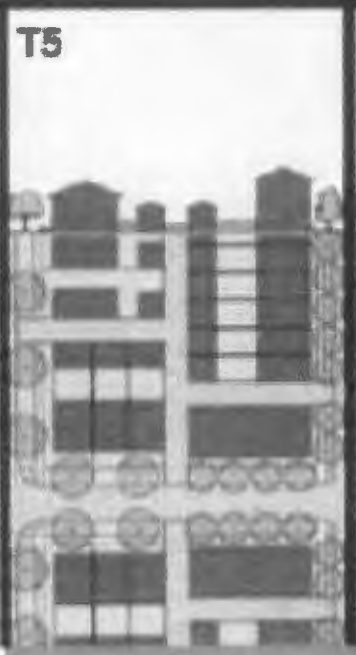
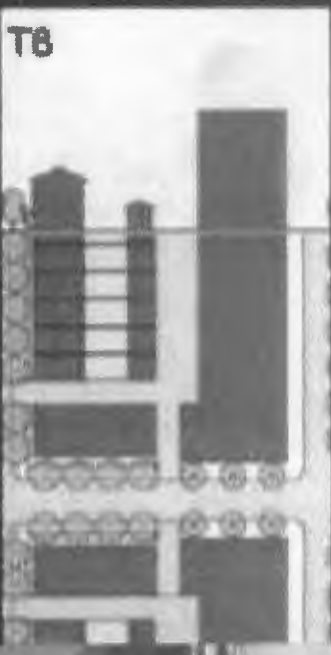

Legend

 LopezTrust

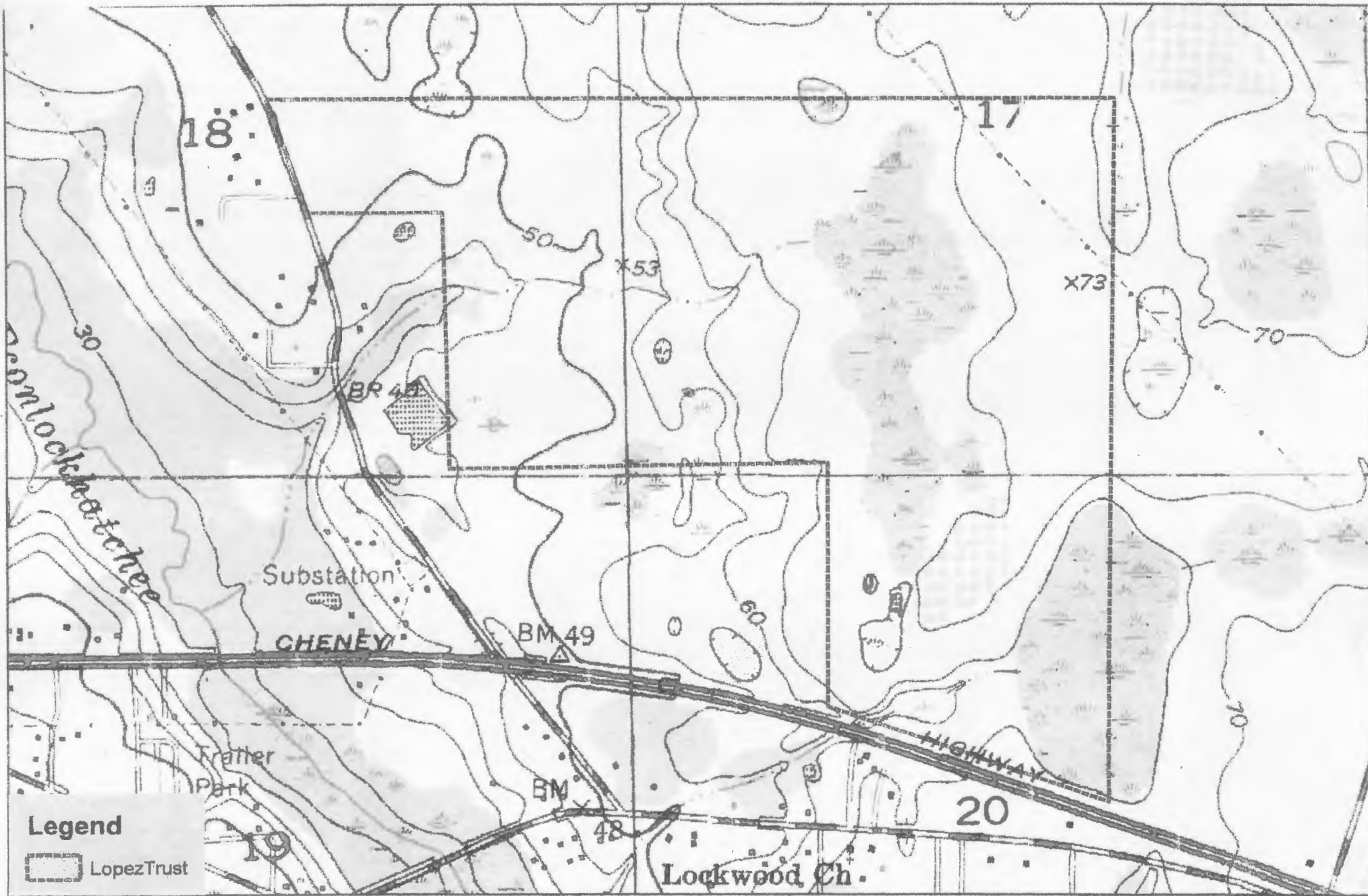
Lopez Trust Project
 Orange County, FL
 Figure 3
 Oviedo SW Quad Map

2

 1,250 Feet

Project #: 672-09.03
 Produced By: JEB
 Date: 10-14-13



The GROW PD-RP

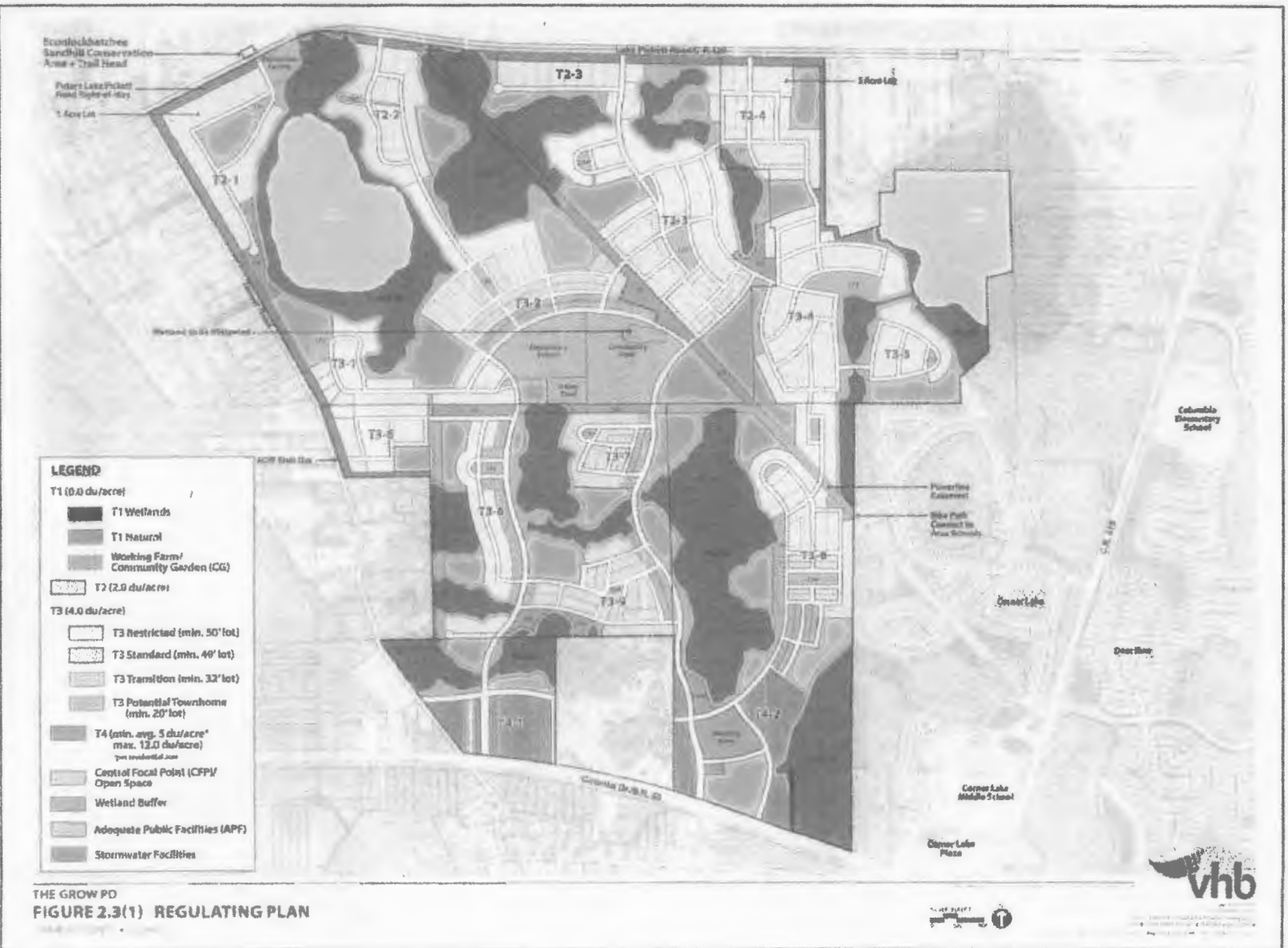

2.0 Transects

(e) Live/Work Units

- A. Elevated first floor.
- B. Porches and entries are detailed to the same level or at a higher level than the main body. Porch foundations, columns, railings, eaves, and ceiling treatment are all elements that define the style.
- C. Recessed front facade plane.
- D. Facade material variation.
- E. Multiple roof forms, such as gables and hips.

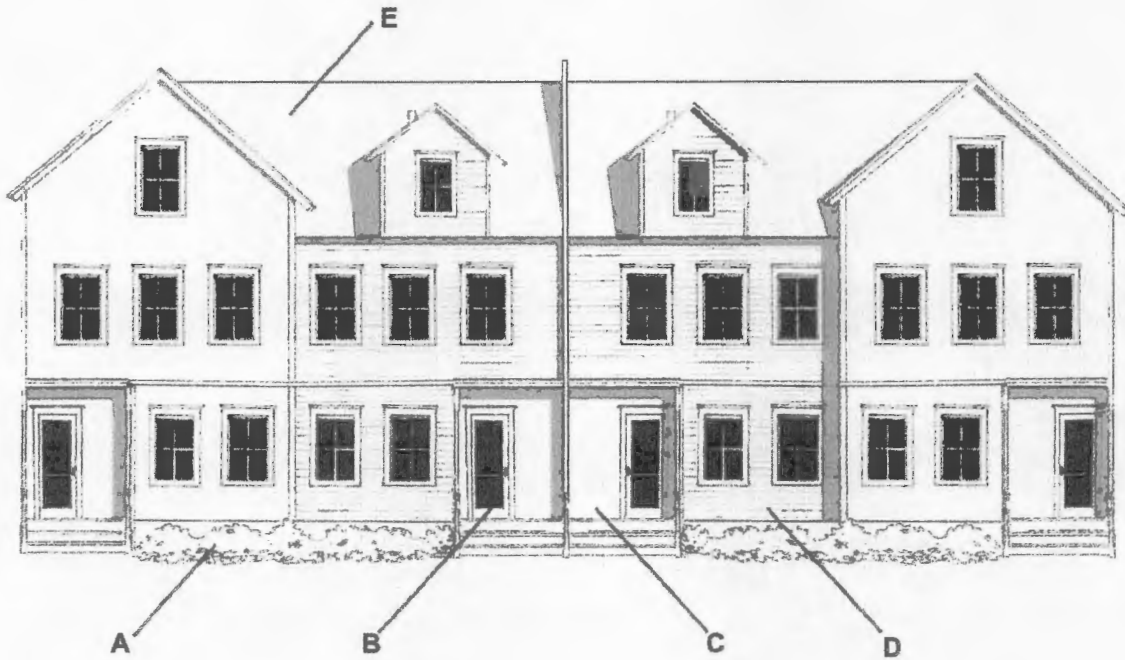

References: *Oakland Park Pattern Book*