



Interoffice Memorandum

DATE: March 24, 2016

TO: Katie A. Smith, Deputy Clerk of the Board of County Commissioners, County Comptroller's Office

THROUGH: Cheryl Gillespie, Supervisor, Agenda Development Office

FROM: Alberto A. Vargas, MArch., Manager, Planning Division

CONTACT PERSON: **John Smogor, Planning Administrator**
Planning Division 407-836-5616 and
john.smogor@ocfl.net

SUBJECT: Request for Board of County Commissioners (BCC) Public Hearing

Project Name: Hollywood Plaza Parking Garage Planned Development (PD) - Case # CDR-16-02-050

Type of Hearing: Substantial Change

Applicant: Joshua Wallack

Commission District: 6

General Location: 8050 International Drive; south of Sand Lake Road, west of International Drive.

BCC Public Hearing Required by: Orange County Code, Chapter 30, Article III, Section 30-89 and Orange County Code, Chapter 38, Article VIII, Division 1, Section 38-1207

4-26-16
2pm.

**Clerk's Advertising
Requirements:**

(1) At least 15 days before the BCC public hearing date, publish an advertisement in the Legal Notices section of *The Orlando Sentinel* describing the particular request, the general location of the subject property, and the date, time, and place when the BCC public hearing will be held;

and

(2) At least 10 days before the BCC public hearing date, send notices of BCC public hearing by U.S. mail to owners of property within 300 feet of the subject property and beyond.

Spanish Contact Person: IF YOU HAVE ANY QUESTIONS REGARDING THIS NOTICE, CONTACT THE ORANGE COUNTY PLANNING DIVISION, Email: lourdes.o'farrill@ocfl.net 407-836-5686

PARA MÁS INFORMACIÓN, REFERENTE A ESTA VISTA PUBLICA CON RESPECTO A UNA AUDENCIA PUBLICA SOBRE PROPIEDAD EN SU AREAVECINDAD, FAVOR COMUNICARSE CON LA DIVISIÓN DE PLANIFICACION, AL NUMERO, 407-836-5684.836-5686

Advertising Language:

A substantial change request to increase the parking garage square footage from 226,502 square feet to 310,000 square feet.

Material Provided:

- (1) Names and last known addresses of property owners within 300 feet and beyond (*via email from Fiscal and Operational Support Division*); and
- (2) Location map (*to be mailed to property owners*).

Special instructions to the Clerk:

Please place this request on the next available BCC agenda. Unless stated otherwise, the public hearing should be advertised to begin at 2:00 p.m., or as soon thereafter as the matter may be heard.

Attachment (location map)

c: Chris R. Testerman, AICP, Assistant County Administrator
Jon V. Weiss, Director, Community Environmental Development Services
Department

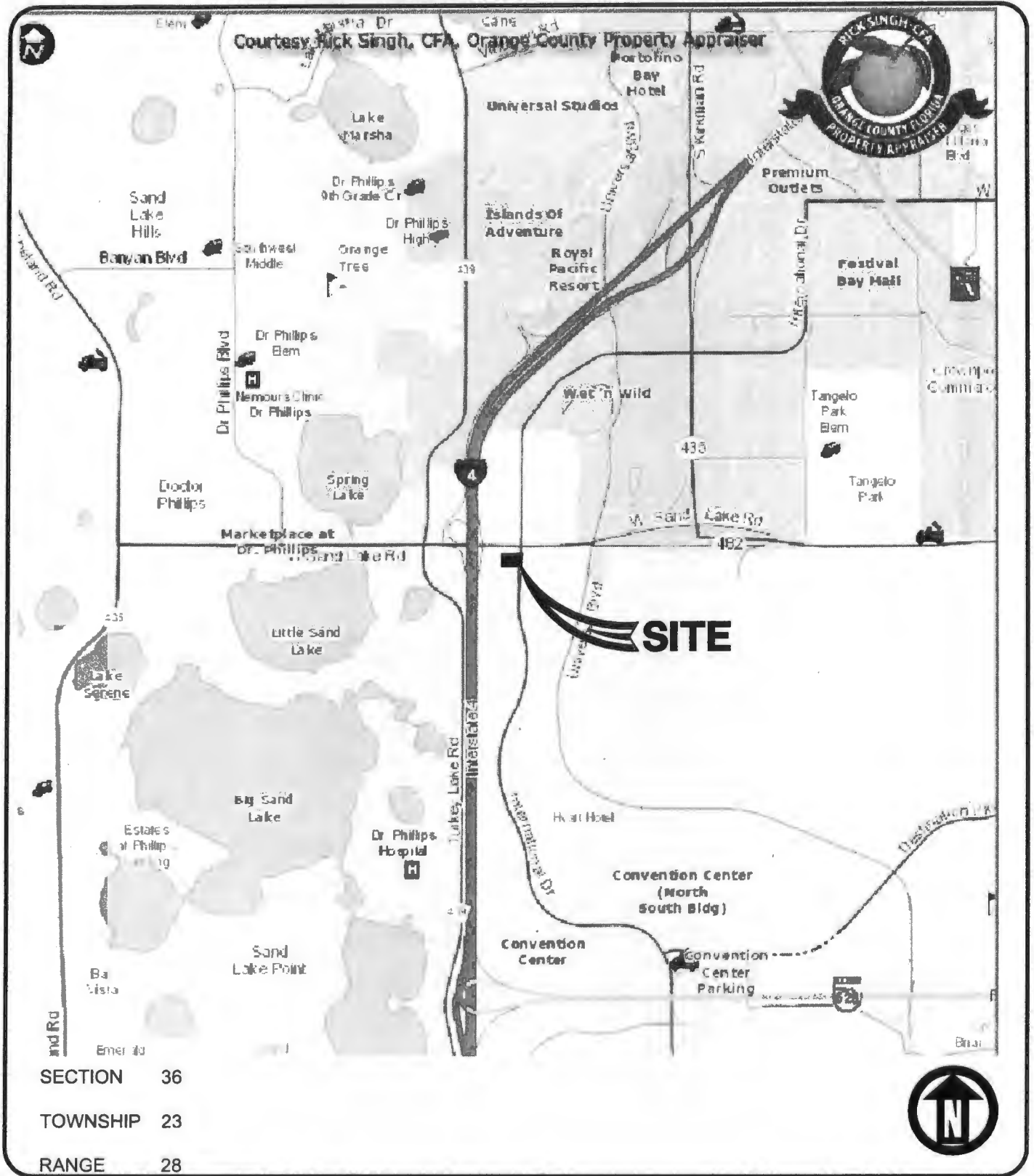

Burkett
 engineering

105 E. Robinson Street, Suite 501 Orlando, Florida 32801
 (407) 261-5616

CIVIL ENGINEERING
 CONSULTANTS

HOLLYWOOD PLAZA PARKING GARAGE
LOCATION MAP

ORANGE COUNTY PROPERTY APPRAISER

EXHIBIT 1

DATE 8/06/14
 NET JOB No. 1407.11
 SCALE 1"=3,000'

If you have any questions regarding this map, please call John Smogor at 407-836-5616.

Case #CDR-16-02-050
 Hollywood Plaza Parking Garage PD

Case #CDR-16-02-050
Hollywood Plaza Parking Garage PD

HOLLYWOOD PLAZA PARKING GARAGE
LEGAL DESCRIPTION

Lot 1, Hollywood Plaza, according to the map or plat thereof, as recorded in Plat Book 36, Page 98, of the Public Records of Orange County, Florida.