



Interoffice Memorandum

APPROVED
BY ORANGE COUNTY BOARD
OF COUNTY COMMISSIONERS

JAN 05 2016 *SLK/LC*

December 10, 2015

TO: Mayor Teresa Jacobs
and Board of County Commissioners

FROM: Mark V. Massaro, P. E., Director, Public Works Department *M*

CONTACT PERSON: Ruby Dempsey Rozier, Manager *RDR*
Traffic Engineering Division

PHONE NUMBER: (407) 836-7890

SUBJ: **Increase the Posted Speed Limit on Dudley Avenue from 25 Miles Per Hour to 35 Miles Per Hour**

At the request of a concerned citizen, Traffic Engineering staff has evaluated the existing posted speed limit on Dudley Avenue in northwest Orange County. The citizen believes that the existing 25 miles per hour posted speed limit presents a speed trap for motorist traveling this road.

Dudley Avenue between Allen Street and Dora Drive is a 2-lane residential street with one house abutting the road. A speed study conducted by staff showed that the 85th percentile speed on Dudley Avenue is 50.5 miles per hour.

Based on driving on this roadway and the results of the speed study, staff recommends that the Board approve increasing the posted speed limit on Dudley Avenue from 25 miles per hour to 35 miles per hour.

Action Requested: Approval to increase the posted speed limit on Dudley Avenue between Allen Street and Dora Drive from 25 miles per hour to 35 miles per hour. District 2.

MVM/RDR/CSY/ns

Attachments



Dudley Avenue Consent Agenda District Map

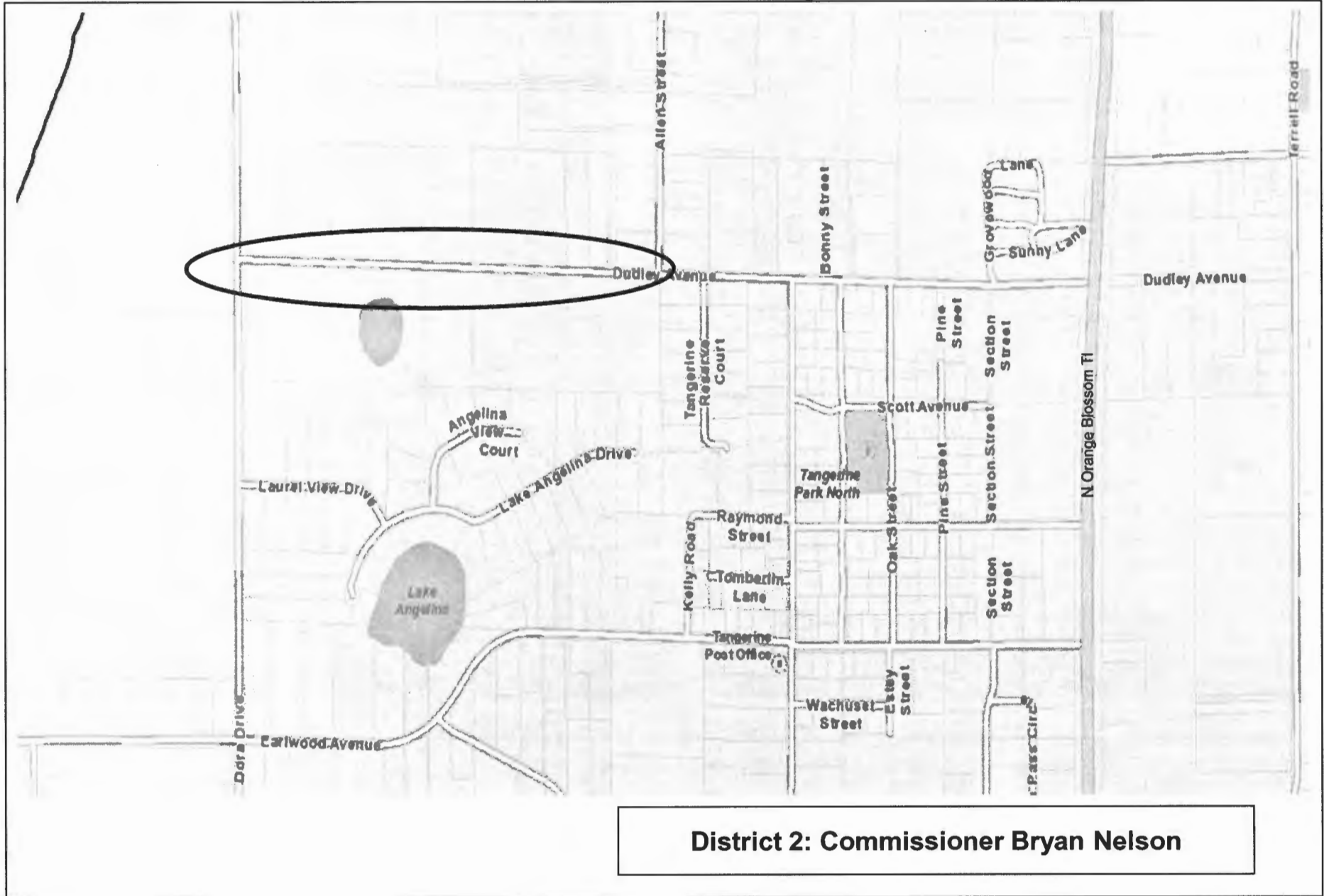



Dudley Avenue Consent Agenda Location Map

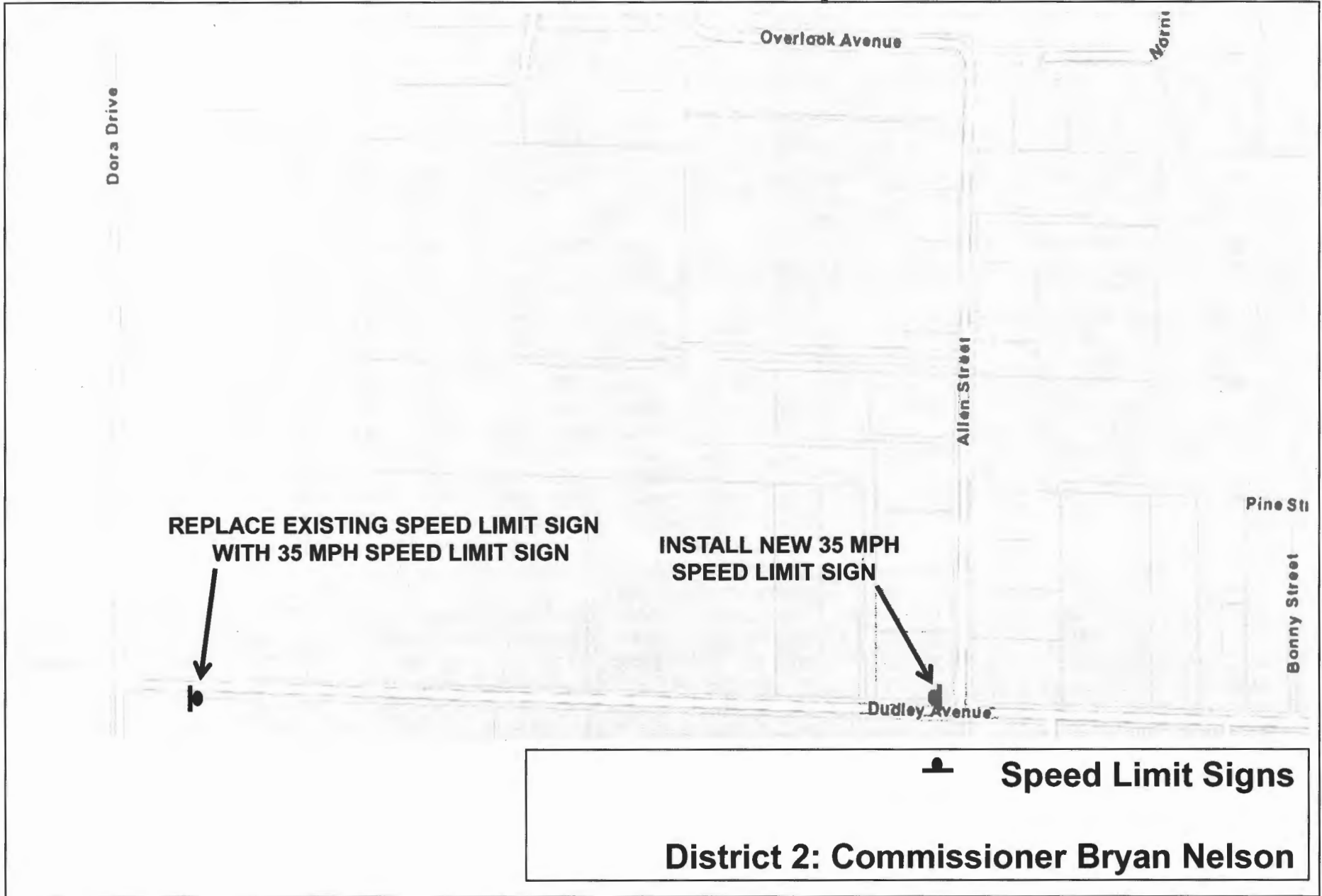

ORANGE COUNTY TRAFFIC ENGINEERING

Dudley Av W/O Allen St

Road	Segment	Date	Posted Speed (mph)	85% Speed	50% Speed	Observed Speeds (Vehicles)										AM Peak	PM Peak
						0-15	16-25	26-30	31-35	36-40	41-45	46-50	51-55	60+	Total		
Dudley Av EB	W/O Allen St	10/06/2015 Tu	25	50.5	41.4	0	2	17	29	42	47	36	30	4	207	8-9A	5-6P
Dudley Av WB	W/O Allen St	10/06/2015 Tu	25	51.7	42.5	0	0	9	27	49	71	34	42	8	240	8-9A	4-5P
Dudley Av EB	W/O Allen St	10/07/2015 We	25	51.2	42.2	0	2	13	15	43	63	28	25	11	200	9-10P	4-5P
Dudley Av WB	W/O Allen St	10/07/2015 We	25	49.9	42.3	1	0	6	25	48	77	41	20	14	232	10-11A	2-3P
Dudley Av EB	W/O Allen St	10/08/2015 Th	25	49.4	40.8	1	2	13	26	41	49	26	19	5	182	8-9A	5-6P
Dudley Av WB	W/O Allen St	10/08/2015 Th	25	50.3	42.6	0	0	5	15	48	77	36	29	5	215	8-9A	6-7P

Dudley Av EB Average
Dudley Av WB Average
Total Average
Total Percent

25	50.37	41.47	0	2	14	23	42	53	30	25	7	196
25	50.63	42.47	0	0	7	22	48	75	37	30	9	229
25	50.50	41.97	1	2	21	46	90	128	67	55	16	425
	0.2%	0.5%	4.9%	10.7%	21.2%	30.1%	15.8%	12.9%	3.7%	100.00		
	0-15	16-25	26-30	31-35	36-40	41-45	46-50	51-55	60+			

Observed Speeds on Dudley Avenue West of Allen Street

