



Interoffice Memorandum

04-02-14P04:49 RCVD

04-02-14P03:44 RCVD

DATE: ~~Continue public hearing to~~
TO: MAY 13 2014

April 1, 2014
Katie A. Smith, Deputy Clerk of the Board of County Commissioners, County Comptroller's Office

THROUGH:

Cheryl Gillespie, Supervisor, Agenda Development Office

FROM:

Lourdes O'Farrill, Development Coordinator Planning Division

CONTACT PERSONS:

Lisette M. Egipciaco,
Development Coordinator
Planning Division 407-836-5684
Lisette.Egipciaco@ocfl.net
&
Lourdes O'Farrill,
Development Coordinator
Planning Division 407-836-5686
Lourdes.O'Farrill@ocfl.net

SUBJECT:

Request for Board of County Commissioners Public Hearing

Project Name:

The Rialto PD / The Rialto Preliminary Subdivision Plan-Substantial Change-Case # CDR-14-02-037

Type of Hearing:

Substantial Change

Applicant(s):

Mr. Ted R. Brown
Holland & Knight, LLP
200 South Orange Avenue, Suite 2600
Orlando, Florida 32801

Commission District:

1

General Location:

North of Sand Lake Road / West of Turkey Lake Road

Parcel ID # (s)

26-23-28-7411-02-000 & 26-23-28-7411-01-000

05/06/14
2:2 pm

of Posters: 2

Use: 200 multi-family dwelling units and 95,000 square feet of commercial use

Size / Acreage: 13.70

BCC Public Hearing Required by: Sections 34-69 and 30-89, Orange County Code

Clerk's Advertising Requirements: (1) At least 7 days before the BCC public hearing date, publish an advertisement in the Legal Notices section of *The Orlando Sentinel* describing the particular request, the general location of the subject property, and the date, time, and place when the BCC public hearing will be held;

And

(2) At least 7 days before the BCC public hearing date, send notices of BCC public hearing by U.S. mail to owners of property abutting and surrounding the subject property.

Spanish Contact Person: Para más información referente a esta vista pública, favor de comunicarse con la División de Planificación (Planning Division) al número 407-836-5686.

Material Provided:

- (1) Names and last known addresses of property owners (*via email from Fiscal and Operational Support Division*);
- (2) Location map (*to be mailed to property owners*);
- (3) Site plan sheet (*to be mailed to property owners*).

SPECIAL INSTRUCTIONS TO CLERK (IF ANY):

Please include the following information in the Notice to Abutters – This request is proposing a substantial change to The Rialto PSP to modify BCC Condition of Approval #3(I); approved by the Board of County Commissioners on September 16, 2008; District 1; North of Sand Lake Road / West of Turkey Lake Road.

Unless stated otherwise, the public hearing should be advertised to begin at 2:00 p.m., or as soon thereafter as the matter may be heard.

Please notify Lourdes O'Farrill and Lisette Egipciano of the scheduled date and time. The Planning Division will notify the applicant.

Attachments (location map and site plan sheet)

c: Chris R. Testerman, AICP, Assistant County Administrator
Jon V. Weiss, Director, Community Environmental Development Services
Department

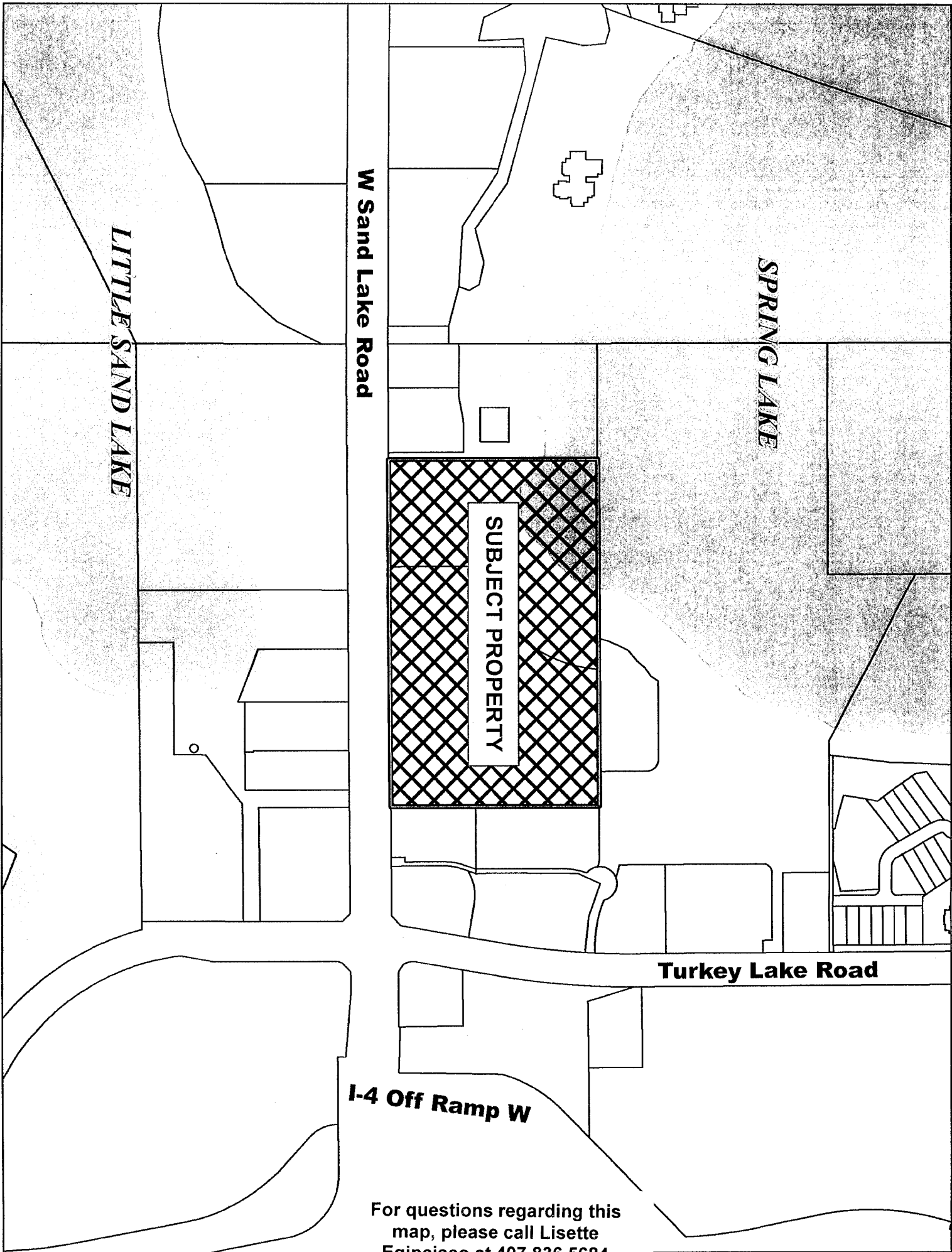

LITTLE SAND LAKE

W Sand Lake Road

SPRING LAKE

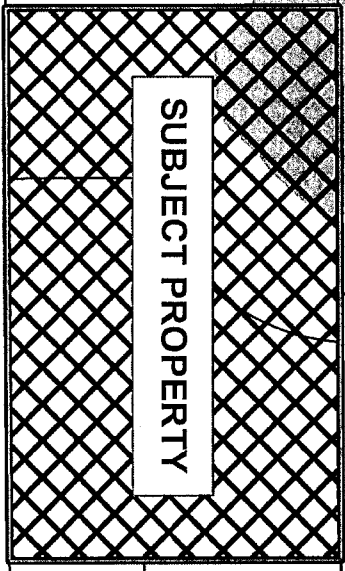

SUBJECT PROPERTY

Turkey Lake Road

I-4 Off Ramp W

For questions regarding this map, please call Lisette Egipciano at 407.836.5684 Or Lourdes O'Farrill at 407-836-5686

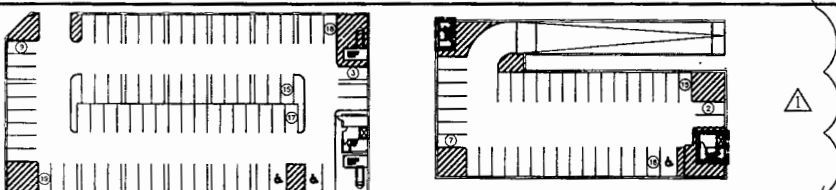

PARKING GARAGE - BASEMENT LEVEL
SCALE: 1" = 40'

PARKING GARAGE - SECOND LEVEL
SCALE: 1" = 40'

NOTES:
1. REFER TO SHEET 3 FOR CROSS SECTIONS.

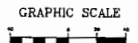

LEGEND

- EWM- EXISTING WATER MAIN
- EWM- EXISTING RECLAIMED WATER MAIN
- ESS- EXISTING SANITARY SEWER
- EPM- EXISTING FORCE MAIN
- ESM- EXISTING SANITARY SEWER MANHOLE
- EST- EXISTING STORM SEWER
- EDM- EXISTING DRAINAGE MANHOLE
- WLM- PROPOSED WATER MAIN
- RWL- PROPOSED RECLAIMED WATER MAIN
- SS- PROPOSED SANITARY SEWER
- SSM- PROPOSED SANITARY SEWER MANHOLE
- SSS- PROPOSED STORM SEWER
- SDM- PROPOSED DRAINAGE MANHOLE
- DOI- PROPOSED DRAINAGE INLET
- PE- PROPOSED SPOT ELEVATION
- DE- DRAINAGE EASEMENT
- FH- FIRE HYDRANT
- CLF- CHAINLINK FENCE
- BSL- BUILDING SETBACK LINE
- FM- FORCEMAIN
- PB- PROPERTY BOUNDARY
- GL- GRADE BREAK LINE
- PC- PARKING SPACE COUNT
- DF- DIRECTIONAL FLOW ARROW
- NHWL- NORMAL HIGH WATER LEVEL
- CE- CONSERVATION EASEMENT
- RPZ/BFP- REDUCED PRESSURE LINE/BACKFLOW PREVENTER
- SSL- SANITARY SEWER LATERAL
- FWM- FIRE WATER SERVICE MAIN
- WM- WATER METER/BFP
- E- ELEVATION
- T- ELECTRICAL TRANSFORMER

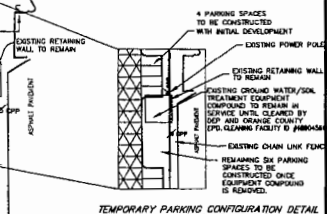
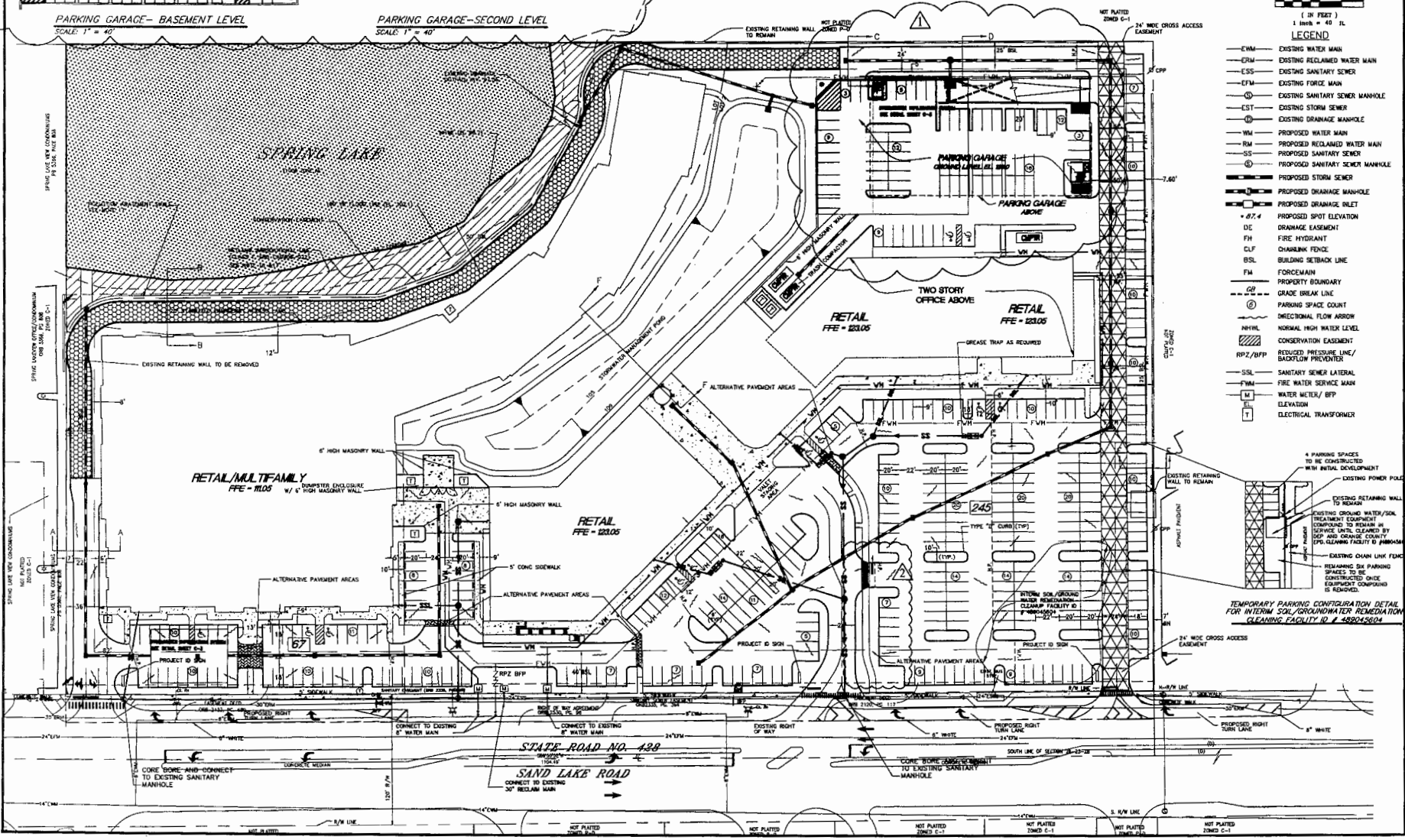

NO.	DATE	DESCRIPTION
1	10/12/20	ISSUED FOR PERMIT
2	10/12/20	ISSUED FOR PERMIT
3	10/12/20	ISSUED FOR PERMIT

THE RIALTO

SITE DEVELOPMENT PLAN

HIGHLAND ENGINEERING, INC.
 1500 Avenue of the Stars, Suite 400
 Irvine, CA 92618
 Phone: 949-451-7777
 Fax: 949-451-7791
 www.hei.com

JOB NO.:	MSJ-001
DESIGNED BY:	JMB
DRAWN BY:	LJC
APPROVED BY:	JMB
DATE:	10/18/20
SHEET:	C-4

NOT FOR CONSTRUCTION UNLESS SIGNED AND SEALED

RONALD D. HODGE, P.E.
 REGISTERED PROFESSIONAL ENGINEER
 NO. 45673