

AA/SP/CS

RESOLUTION NO. 95-M-08

A RESOLUTION ESTABLISHING DESIGNATED TOW-AWAY  
ZONE(S) IN UNINCORPORATED ORANGE COUNTY,  
FLORIDA; AND PROVIDING FOR AN EFFECTIVE DATE.

BE IT RESOLVED BY THE BOARD OF COUNTY COMMISSIONERS OF ORANGE  
COUNTY:

Section 1. Pursuant to Orange County Code, Chapter 35,  
Traffic, Article II, Administration and Enforcement, the County  
Traffic Engineer has recommended to the Board of County  
Commissioners that designated tow-away zones be established at the  
following location(s):

On both sides of the streets and in the median areas  
along International Drive from Orlando city limits  
south to Sea Harbor Drive; along Republic Drive from  
Orlando city limits south to International Drive; and  
along Canadian Court from International Drive,  
proceeding east 1075 feet to the end of the Orange  
County Convention Center parking garage complex.

Section 2. The Board of County Commissioners hereby adopts  
the County Traffic Engineer's recommendation and establishes the  
location(s) described in Section I above as a designated tow-away  
zones(s).

Section 3. The designated tow-away zone(s) herein  
established shall be marked with signs and administered and  
enforced pursuant to Orange County Code, Chapter 35, Article II.

Section 4. Effective Date. This Resolution shall take  
effect immediately upon its adoption.

ADOPTED THIS 7th DAY OF February, 1995.

ORANGE COUNTY, FLORIDA

BY: [Signature] Bob Freeman  
FOR THE County Chairman

DATE: FEB 07 1995

ATTEST: Martha O. Haynie, County Comptroller  
As Clerk of the Board of County Commissioners

BY: [Signature]  
Deputy Clerk

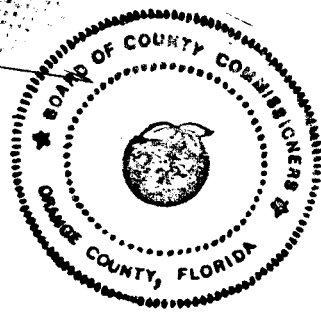

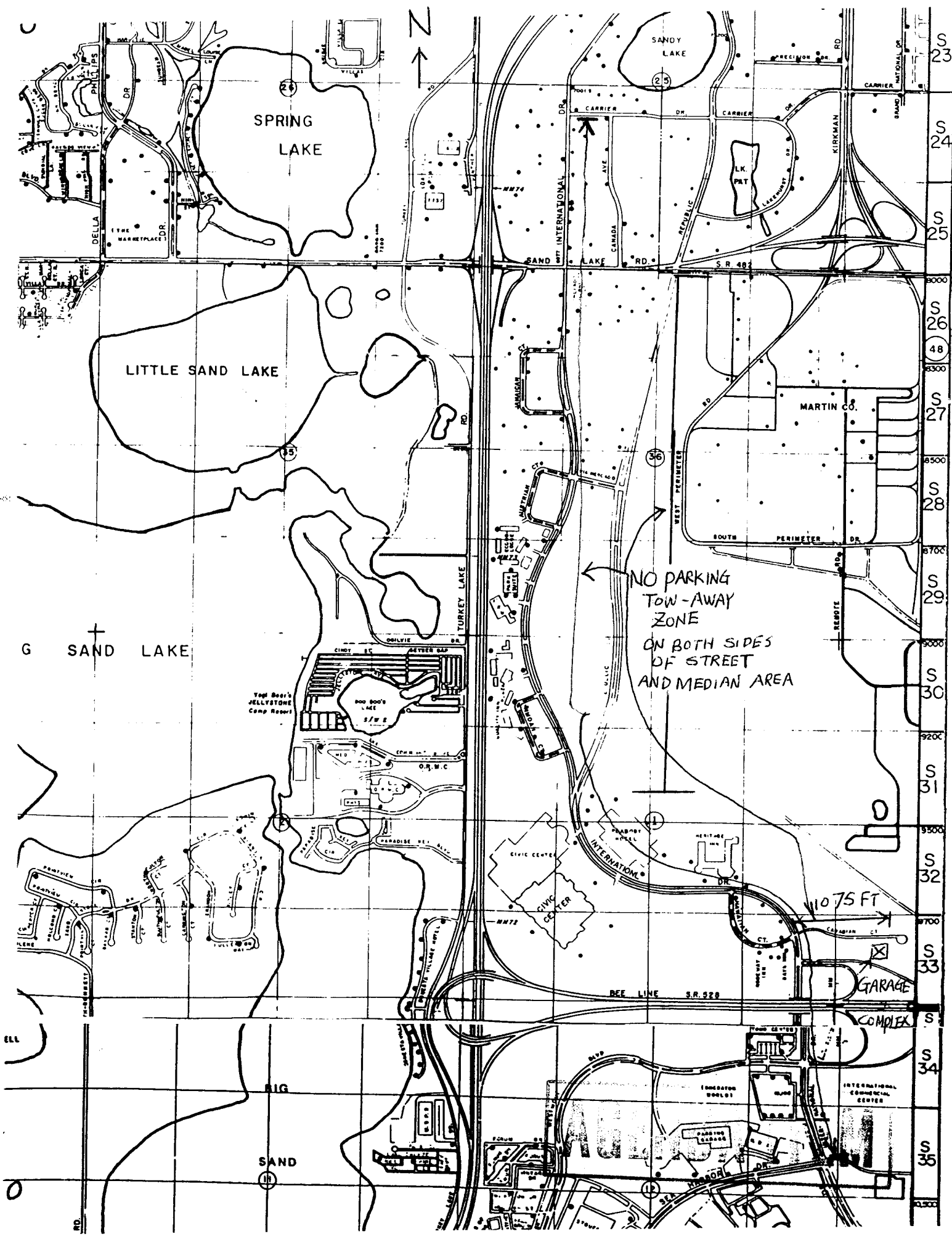

SPRING LAKE

LITTLE SAND LAKE

SAND LAKE

Top Bear's JELLYSTONE Camp Resort

POO BOO'S LAKE

O.R.W.C.

CIVIC CENTER

CIVIC CENTER

NO PARKING  
TOW-AWAY  
ZONE  
ON BOTH SIDES  
OF STREET  
AND MEDIAN AREA

GARAGE

COMPLEX

EMERSON WORLD

INTERNATIONAL COMMERCIAL CENTER

REF. LINE S.R. 928

11075 FT

S 23  
S 24  
S 25  
S 26  
S 27  
S 28  
S 29  
S 30  
S 31  
S 32  
S 33  
S 34  
S 35

C

ELL

RIG

SAND



Orange



County

Orlando, Florida

Interoffice Memo

RECEIVED

JAN - 9 1995

SERVICE COUNTY  
TRAFFIC ENGINEERING DEPT.

January 4, 1995

MEMORANDUM

TO: Steve Wilmarth, Acting Manager/Traffic Engineering  
FROM: Sanh Bui, Operations Manager/OCCC *S. Bui*  
SUBJECT: CANADIAN COURT PARKING GARAGE

As you know, the Convention Center is responsible for the Parking Garage located on Canadian Court and International Drive.

During the past several events held at the Convention Center, where the parking garage was being utilized, vehicles were parked along the access road to the garage (Canadian Court). This practice greatly inhibits safe entrance/exit to the garage.

I am requesting Traffic Engineering to install "NO PARKING" signs along Canadian Court from International Drive to the east end of the access road to the parking garage. *get distance*

Due to the impending use of the parking garage during PGA, (30,000 plus attendees) this must be completed no later than 1/20/95.

I appreciate your immediate attention to this request. Should you need additional information or have any questions, please do not hesitate to call me at 345-9863.

SNB:slr

c: Jessie Allen, Deputy Director  
Fred Blankenship, Ass't Bldg Security Supv  
David White, Traffic Coord.



AGENDA ITEM