

APR 16 1991

Page 1 c

RESOLUTION NO. 91-M-14

A RESOLUTION ESTABLISHING A MAXIMUM SPEED
LIMIT OF 25 MILES PER HOUR FOR THE RESI-
DENTIAL DISTRICT KNOWN AS _____
Long Lake Park Subdivision

WHEREAS, Section 316.189 and Section 316.183, Florida
Statutes, as amended by Chapter 88-47, Laws of Florida,
authorizes a county to set a maximum speed limit of 25 miles
per hour for a residential district after an investigation
determines that such a limit is reasonable; and

WHEREAS, Orange County has determined after an investi-
gation that the maximum speed limit should be 25 miles per
hour for the residential district known as _____
Long Lake Park Subdivision

NOW, THEREFORE, BE IT HEREBY RESOLVED BY THE BOARD OF
COUNTY COMMISSIONERS OF ORANGE COUNTY, FLORIDA:

1. The maximum speed limit shall be 25 miles per hour
for all streets located within the residential district known
as Long Lake Park Subdivision.

2. This Resolution shall become effective upon the
date of its adoption.

ADOPTED THIS 16th DAY OF April, 1991.

ORANGE COUNTY, FLORIDA

BY: [Signature]
Chairman, Board of County
Commissioners

ATTEST: MARTHA O. HAYNIE, Clerk,
Board of County Commissioners

BY: [Signature]
Deputy Clerk

NGE COUNTY FIRE / RESCUE DIVISION

TOWNSHIP 21 SOUTH

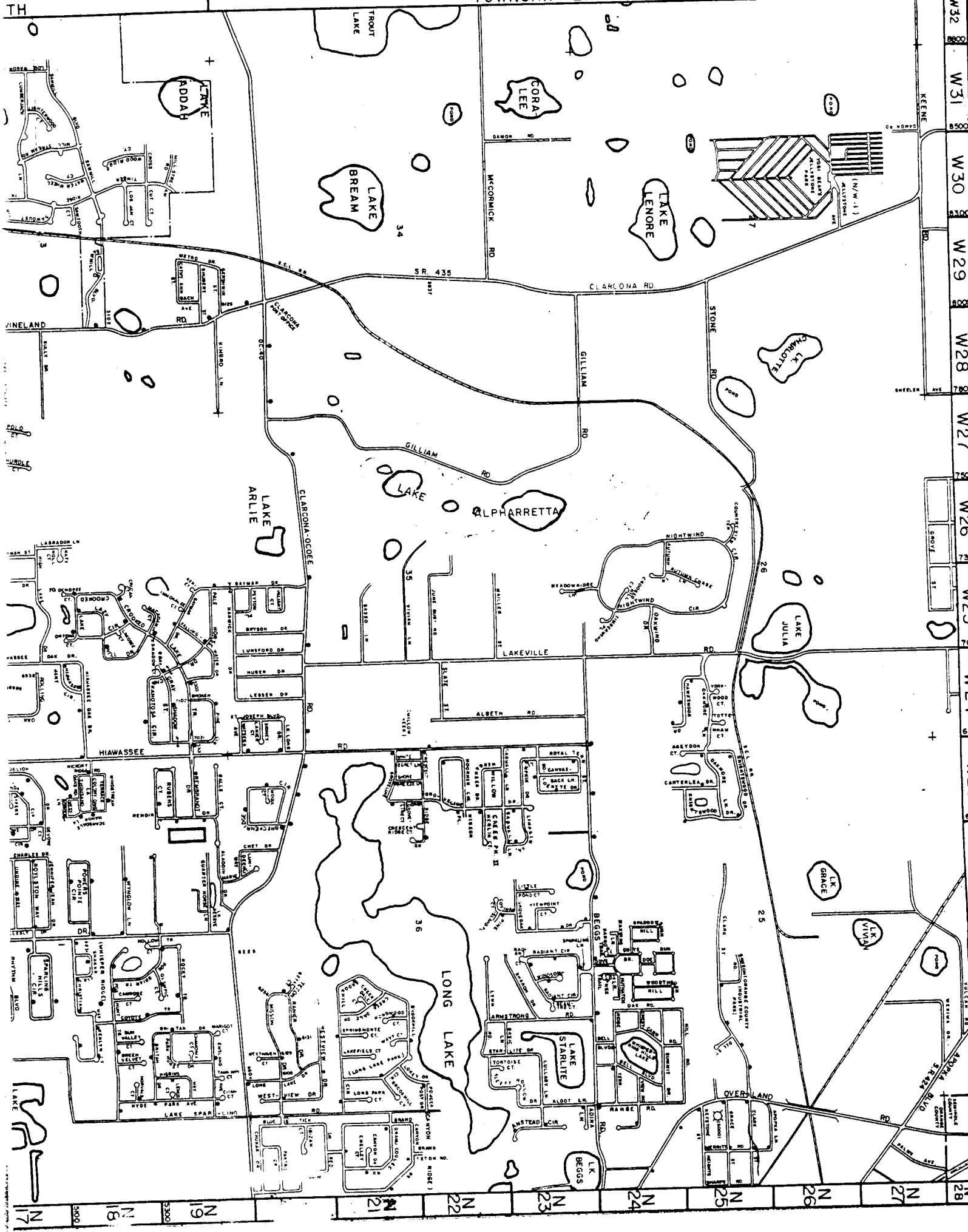

34
W32
W31
W30
W29
W28
W27
W26
W25
W24
W23
W22
W21
W20
W19
W18
W17

N28
N27
N26
N25
N24
N23
N22
N21
N20
N19
N18
N17